

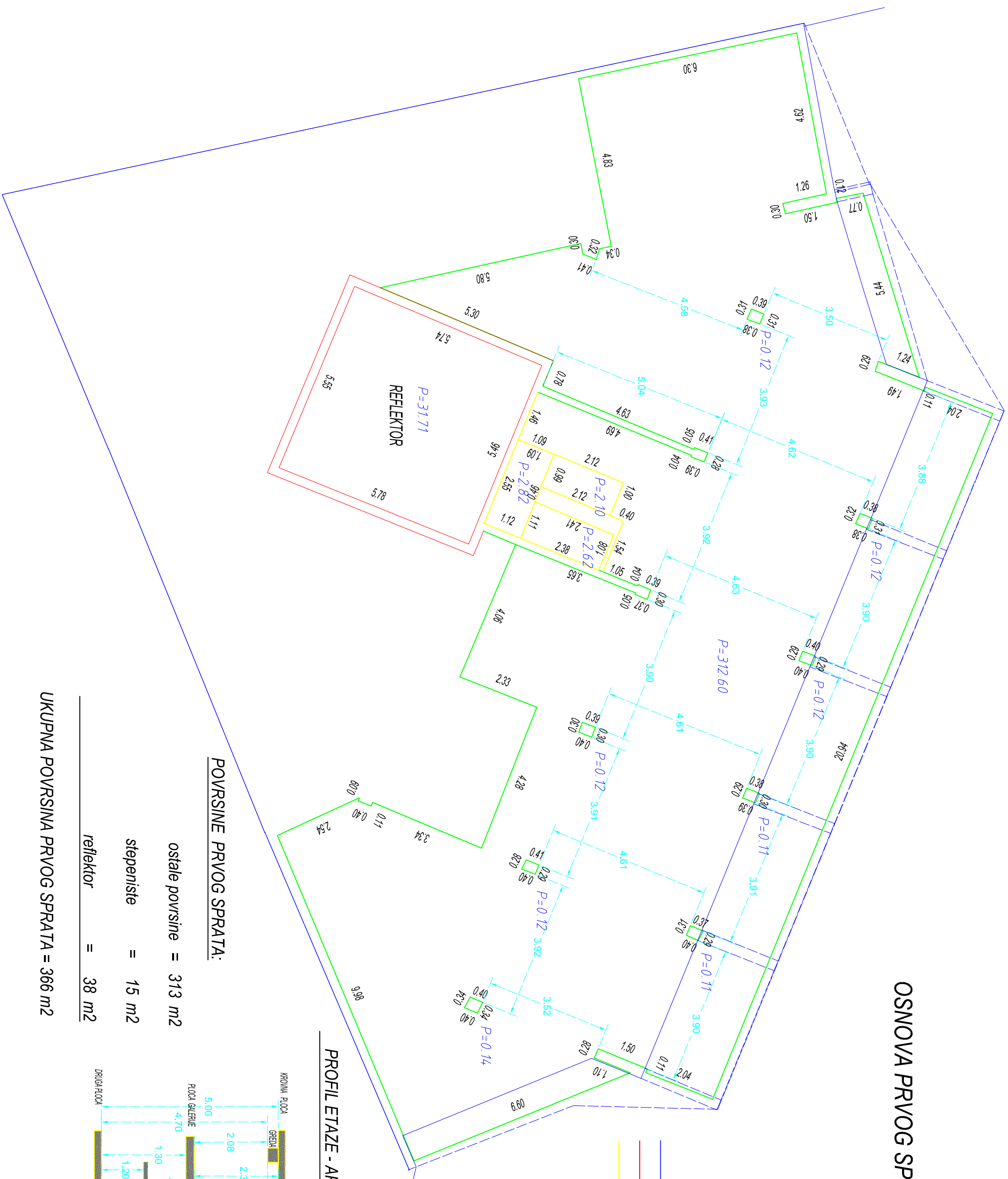

OSNOVA PRVOG SPRATA



- LEGENDA:**
- | | |
|---|------------------------|
|  | GABARIT OBJEKTA |
| | ZIDOV I STUBOVI |
|  | STEPENISTE |

PROFIL ETAZE - APSOLUTNE KOTE

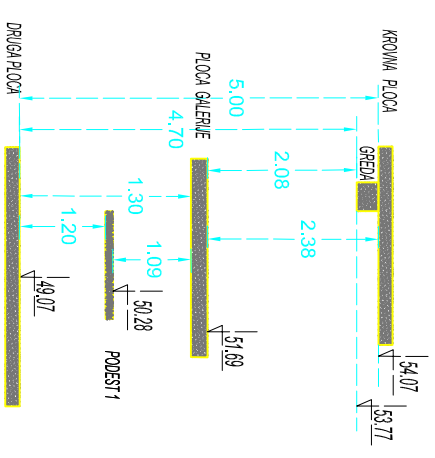

POVRŠINE PRVOG SPRATA:

ostale površine = 313 m²

stepeniste = 15 m2

$$\frac{\text{reflektor}}{\text{reflektor}} = 38 \text{ m}^2$$

UKUPNA POVRŠINA PRVOG SPRATA = 366 m²